

RevNo	Revision note	Date	Signature	Checked
-------	---------------	------	-----------	---------

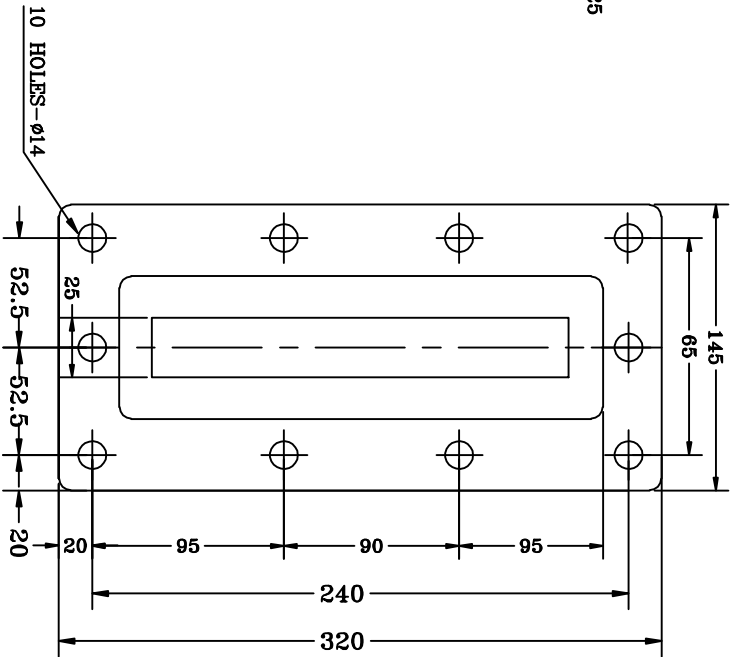
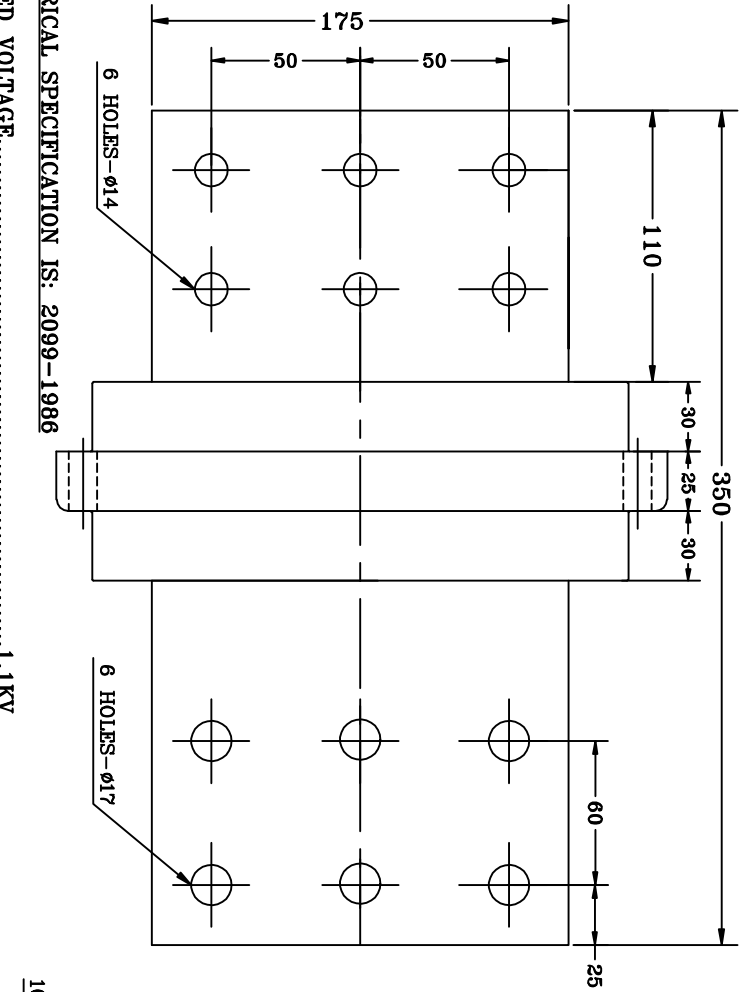

ELECTRICAL SPECIFICATION IS: 2099-1986

- 1 RATED VOLTAGE.....1.1KV
- 2 DRY POWER FREQUENCY WITHSTAND VOLTAGE TEST (ONE MINUT)...5 KV
- 3 MAXIMUM CURRENT CAPACITY.....6300 AMP.

NOTES:-

- 1 END COPPER PAIM WILL BE ELECTRONNED 12 TO 15 MICRONS.
- 2 ELECTOLYTIC COPPER WITH HIGH ELECTRICAL CONDUCTIVITY.
- 3 COLOUR BRICK RED.
- 4 ALL DIMENSION ARE IN MM.

01	1.1 kv,6300A	DISCRIPPTON
TYPE	EPOXY RESINE CAST BUSHING	
	ITEM CODE: FF0119	
	DRN.	SIGN
	CHD.	KINJAL
	APPD.	AP
		DATE
		29.04.10



MANUFACTURER
Fibre & Fibre Glass Products
250/7, MAGAZINE HOUSE
G.I.D.C. MAKARPURA,
VADODRA- 390010

DRAWING NO.:
FRGP-062/11-12

Sheet Edition
1/1 0 REV
0