

1	2	3	4
RevNo	Revision note	Date	Signature
			Checked

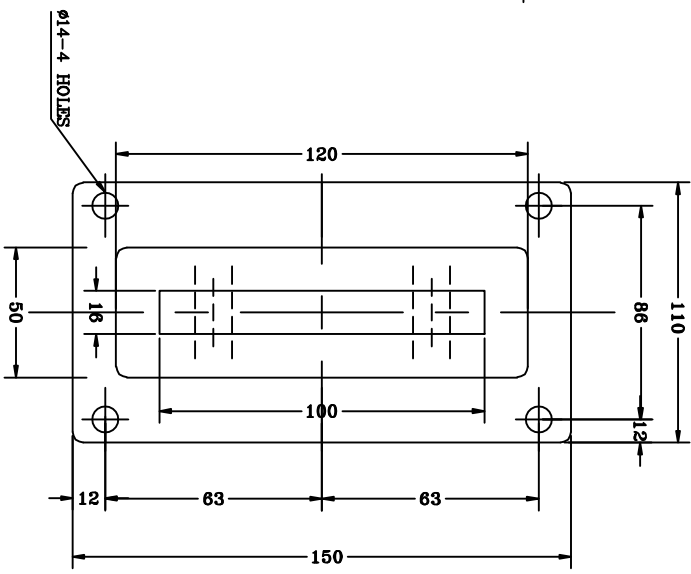
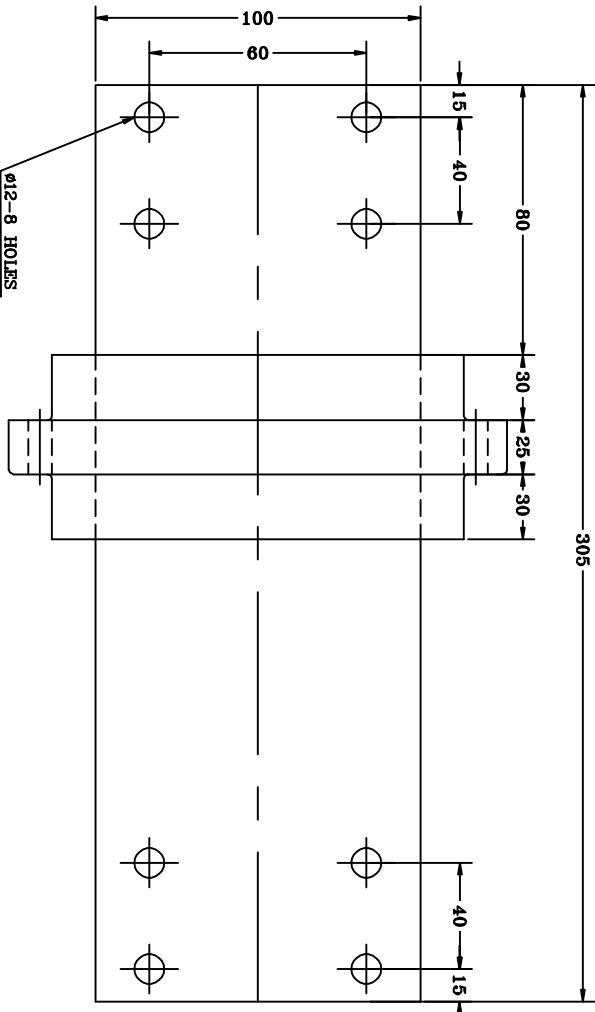

**ELECTRICAL SPECIFICATION IS: 2099-1986**

- 1 RATED VOLTAGE.....1.1KV
- 2 DRY POWER FREQUENCY WITHSTAND VOLTAGE (ONE MINUT)...5 KV
- 3 MAXIMUM CURRENT CAPACITY.....2500 AMP.

**OTHER:**

- 1 END COPPER PALM WILL BE ELECTRONNED 12 TO 15 MICRONS.
- 2 ELECTROLYTIC COPPER WITH HIGH ELECTRICAL CONDUCTIVITY.
- 3 COLOUR BRICK RED.
- 4 ALL DIMENSION ARE IN MM.

01	1.1 kv, 2500A	DISCRIPITION		TYPE	01
		EPOXY RESINE CAST BUSHING			
		ITEM CODE: FF0118		THIRD ANGLE	
		MANUFACTURER			
		Fibre & Fibre Glass Products		250/7, MAGAZINE HOUSE G.I.D.C. MAKARPURA, VADODARA - 380010	
		DRAWING NO.:		FFGP/061/10-11	
		DRN.		SIGN	
		CHD.		DATE	
		APPD.		KINJAL 23.06.2010	
		Sheet		Edition	
		1/1		0	
		REV		01	