

Revision note	Date	Signature	Checked
---------------	------	-----------	---------

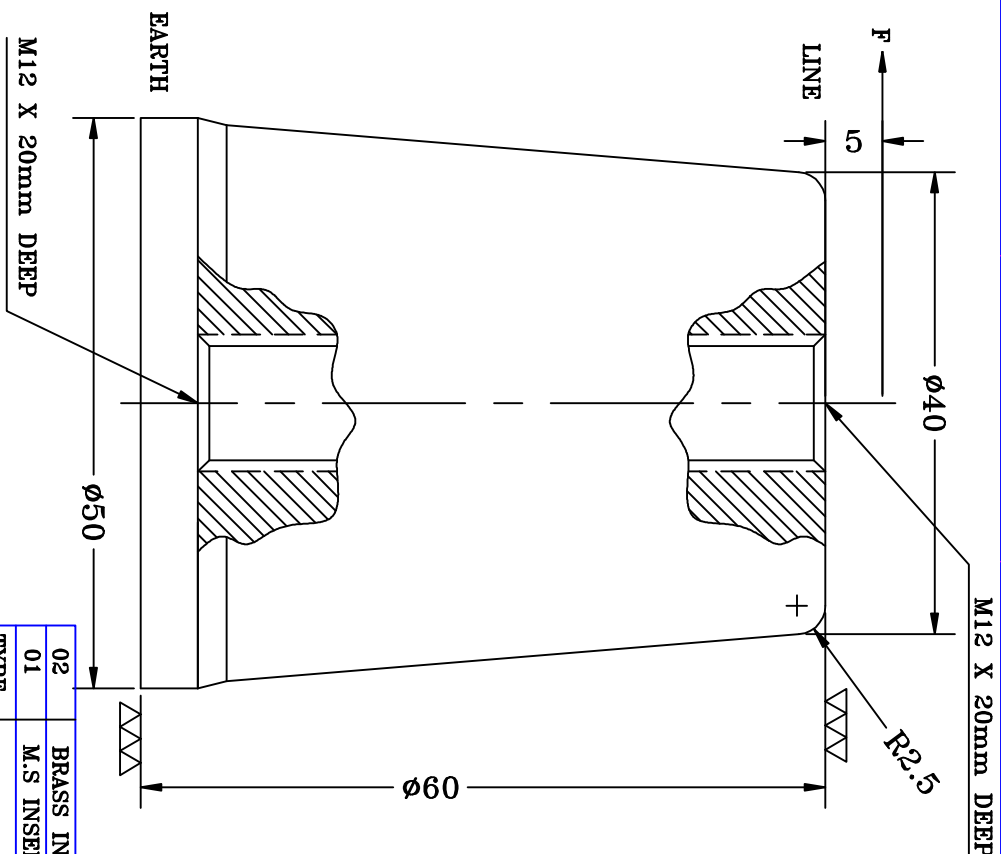

MECHANICAL SPECIFICATION IS: 9431-1979

- 1 TENSILE FALLING LOAD.....1800Kg
- 2 COMPRESSION FALLING LOAD.....4000Kg
- 3 CANTILEVER FALLINGS LOAD.....425Kg

ELECTRICAL SPECIFICATION IS: 9431-1979

- 1 RATED VOLTAGE.....1.2kv
 - 2 DRY POWER FREQUENCY WITHSTAND VOLTAGE TES..10kv
 - 3 MINIMUM CREEPAGE DISTANCE.....63mm
 - 4 IMPULSE WITHSTAND VOLTAGE.....40kv
 - 5 DRY FLASHOVER VOLTAGE.....35kv
- OTHERS**
- 1 COLOUR BRICK RED.
 - 2 ALL DIMENSION ARE IN MM.

02	BRASS INSERTS				
01	M.S INSERT WITH WHITE ZINK PLATING				
TYPE		DISCRIPTION			
		1.2kv			
		EPOXY RESINE CAST INSULATOR			
		ITEM CODE: FF0084			
		DRN.	SIGN	DATE	
		CHD.	TANVI	15/03/08	
		APPD.	AP	-	



Fibre & Fibre Glass Products
 280/7, MAGAZINE HOUSE
 G.I.D.C. MAKARPURA,
 VADODARA - 390010

DRAWING NO.:
 FFGP/029/08-09

Sheet Edition
 1/1 0

REV
 0