

4 Signature Checked  
 3 Date  
 2 Revision note  
 1

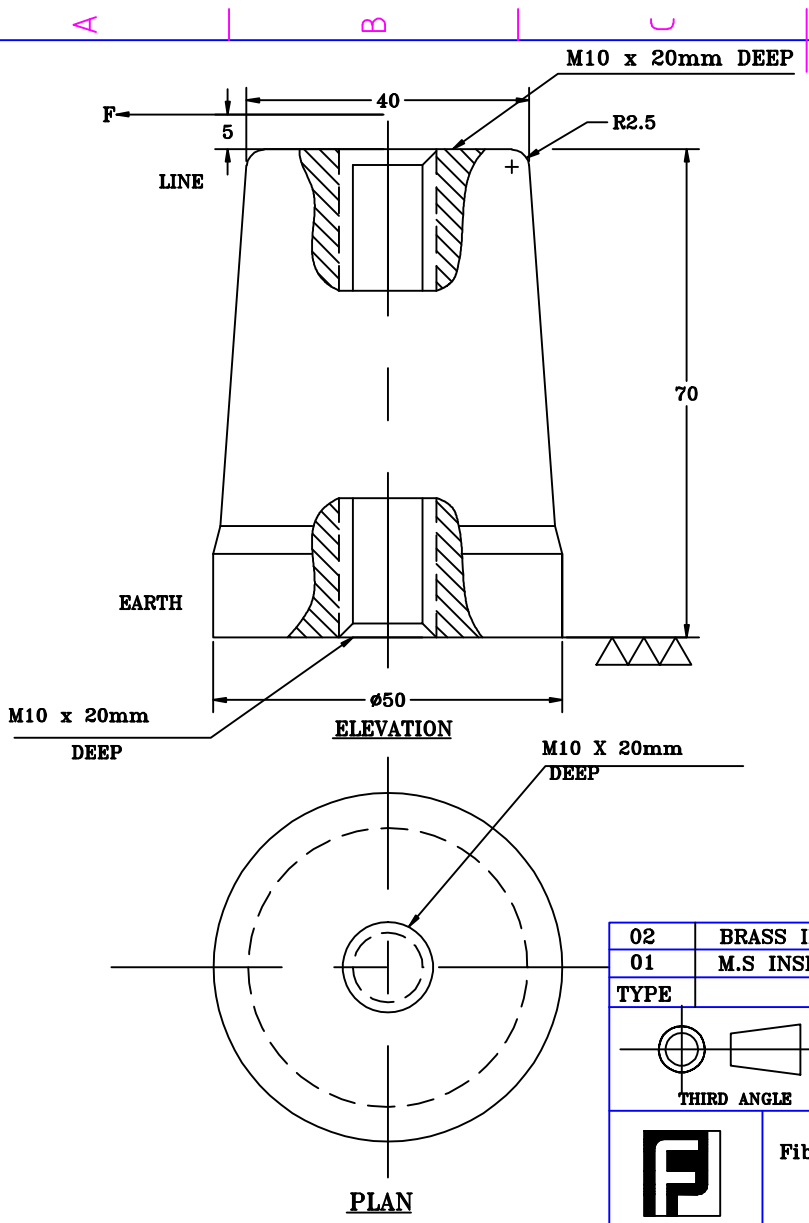

**MECHANICAL SPECIFICATION IS: 9431-1979**

- 1 TENSILE FALING LOAD.....1800Kg
- 2 COMPERSSION FALLING LOAD.....4000Kgs.
- 3 CANTILEVER FALINGS LOAD.....400Kg
- 4 TORSION STRENGTH OF INSERTSS.....
- 5 TORSION STRENGTH OF BODY OMRE THAN.....15mkg

**ELECTRICAL SPECIFICATION IS: 9431-1979**

- 1 MI. CURRENT CAPACITY.....Amps.
- 2 RATED VOLTAGE.....3.3kv
- 3 DRY FLASHOVER VOLTAGE.....40kv
- 4 ONE MINUTE WITH DRY WITHSTAND VOLATEGE...21kv
- 5 IMPULSE WITHSTAND VOLTAGE.....45kv
- 6 CREEPAGE DISTANCE.....73mm.

**NOTES:**  
 1 ALL DIMENTION ARE IN MM.

02	BRASS INSERTS			
01	M.S INSERT WITH WHITE ZINK PLATING			
TYPE		DISCRIPTION		
 THIRD ANGLE		3.3kv	SIGN	DATE
		EPOXY RESINE CAST INSULATOR	DRN.	TANVI 30/03/07
		ITEM CODE : FF0071	CHD.	AP -
			APPD.	-
		<b>MANUFACTURER</b> Fibre & Fibre Glass Products 250/7, MAGAZINE HOUSE G.I.D.C. MAKARPURA, VADODARA- 390010		DRAWING NO.: FFGP-006/07-08
	Sheet	Edition	REV	
	1/1	0	01	

4  
3  
2