

Revision note | Date | Signature | Checked

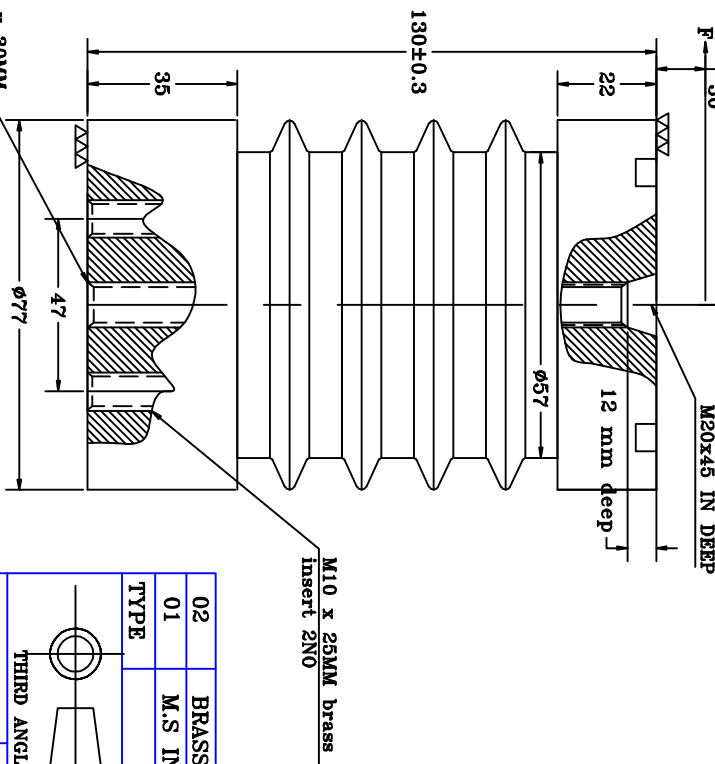
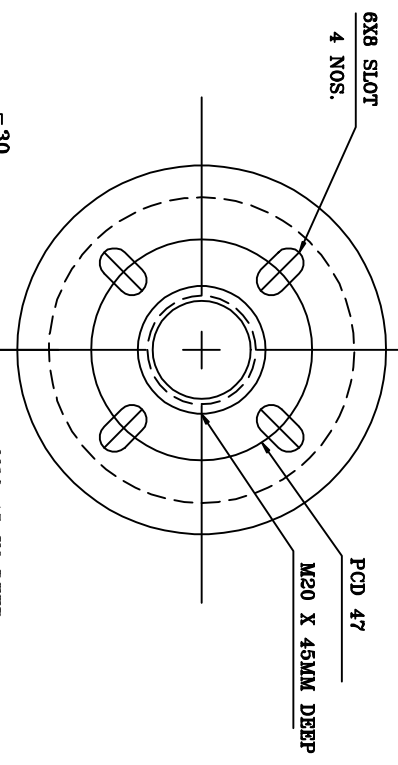

- MECHANICAL SPECIFICATION IS:9431-1979**
- 1 TENSILE FAILING LOAD.....1000Kg
  - 2 COMPRESSION FAILING LOAD.....10000Kg
  - 3 CANTILEVER FAILINGS LOAD.....500Kg
- ELECTRICAL SPECIFICATION IS:9431-1979**
- 1 RATED VOLTAGE.....11kv
  - 2 DRY POWER FREQUENCY WITHSTAND VOLATEGE TEST(ONE MINUT).....35kv
  - 3 MINIMUM CREEPAGE DISTANCE.....175mm
  - 4 DRY LIGHTING IMPULS WITHSTAND VOLATEGE TEST.....95kv Peak

- OTHERS**
- 1 COLOUR BRCK RED.
  - 2 ALL DIMENSION ARE IN MM.

02	BRASS INSERTS	DISCRPTION	11kv EPOXY RESINE CAST INSULATOR	DRN.	SIGN	DATE
01	M.S INSERT WITH WHITE ZINK PLATING					
TYPE		ITEM CODE: FF0059	APPD.			

**MANUFACTURER**  
Fibre & Fibre Glass Products  
250/7, MAGAZINE HOUSE  
G.I.D.C. KARURURA,  
VADODARA- 390010

**DRAWING NO.:** FFGP-022/09-10  
**Sheet Edition** 1/1  
**REV** 0

