

Revision note	Date	Signature	Checked
---------------	------	-----------	---------

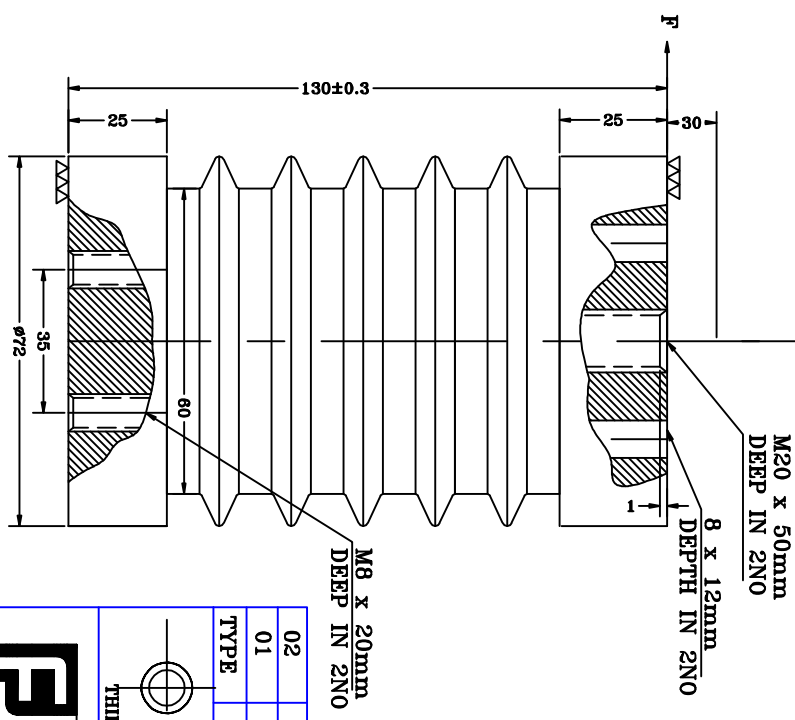
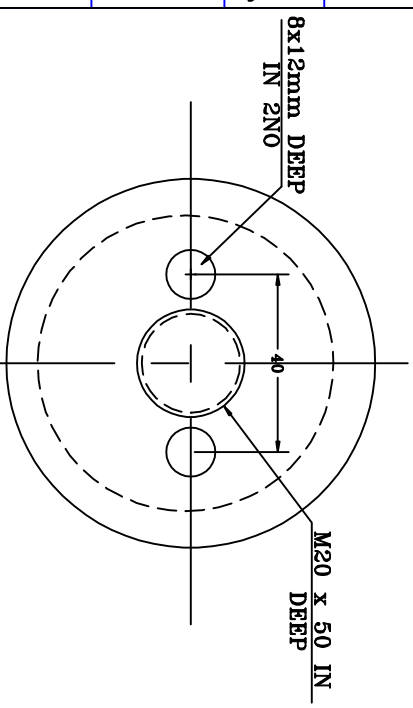

MECHANICAL SPECIFICATION IS:9431-1979

- 1 TENSILE FAILING LOAD.....1000Kg
- 2 COMPRESSION FAILING LOAD.....10000Kg
- 3 CANTILEVER FAILINGS LOAD.....500Kg

ELECTRICAL SPECIFICATION IS:9431-1979

- 1 RATED VOLTAGE.....11kv
 - 2 DRY POWER FREQUENCY WITHSTAND VOLATEGE TEST(ONE MINUT).....35kv
 - 3 MINIMUM CREEPAGE DISTANCE.....176mm
 - 4 DRY LIGHTING IMPULS WITHSTAND VOLATEGE TEST.....75kv Peak
- OTHERS**
- 1 COLOUR BRICK RED.
 - 2 ALL DIMENSION ARE IN MM.

02	BRASS INSERTS	DISCRIPTON	SIGN	DATE
01	M.S INSERT WITH WHITE ZINK PLATING	EPOXY RESINE CAST INSULATOR	DRN.	TANVI 26.01.2009
TYPE		11 kv	CHD.	AP
THIRD ANGLE		ITEM CODE: FP0077	APPD.	-



MANUFACTURER
Fibre & Fibre Glass Products
 250/7, MAGAZINE HOUSE
 G.I.D.C. MAKARPURA,
 VADODRA- 390010

DRAWING NO.:
 FFGP-020/09-10

Sheet Edition
 1/1 0

REV
 0